

P/2017/00426
 REVISED
 RECEIVED 20/7/2017

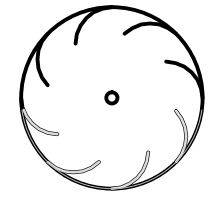

WODWEN - PROPOSED FUTURE DEVELOPMENT

to rear of plots 70-73 to be high timber open side style

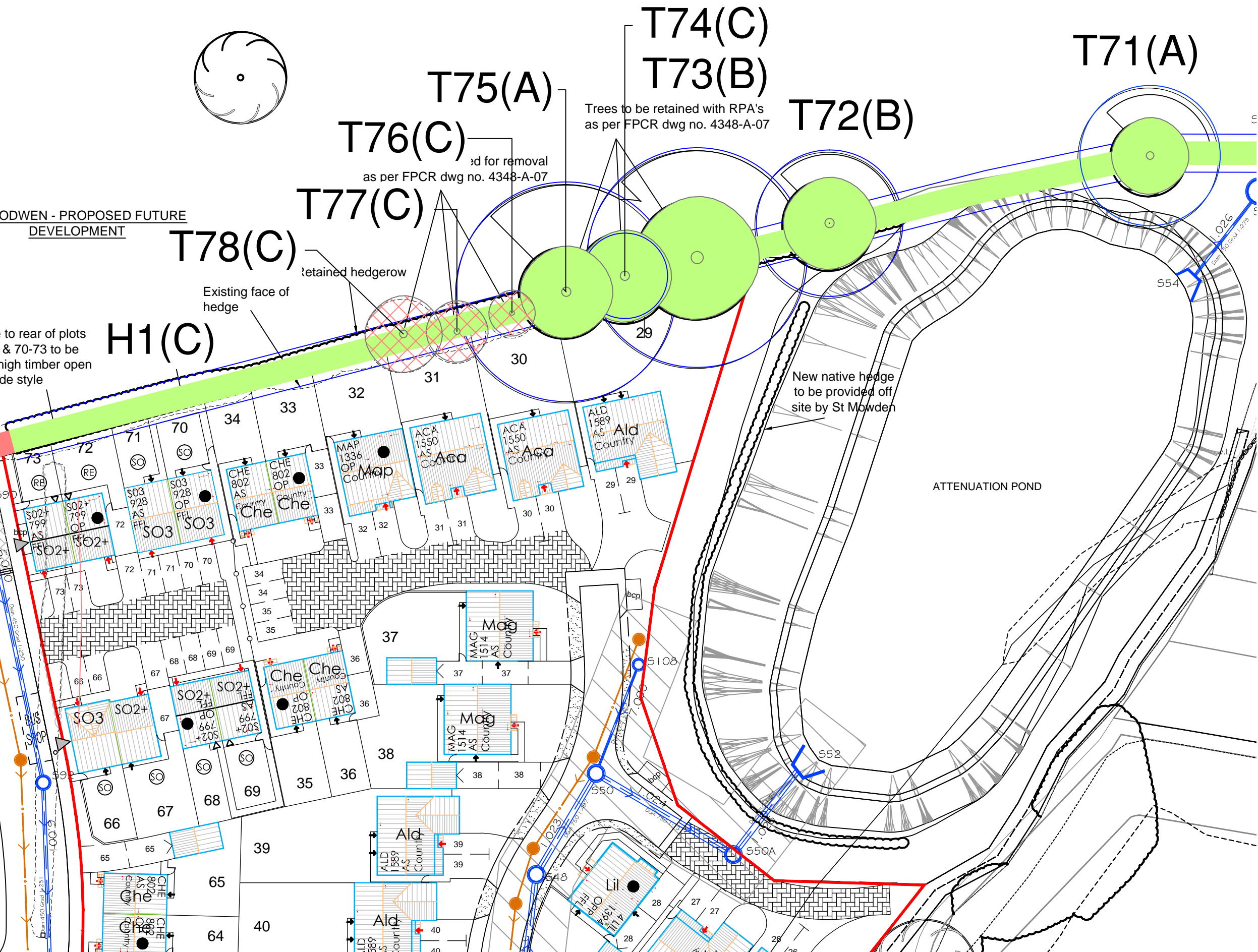

KEY

- Tree/Group to be Retained
- Tree/Group to be removed to facilitate the proposals
- Category U - Unsuitable for retention on arboricultural grounds
- Hedgerow Proposed to be Retained and Incorporated into the New Development
- Hedgerow Proposed to be Removed to Facilitate the Development upon Approval of the Application
- Root Protection Area (Shown for retained trees only)
- Individual / Group Number and BS Category
- Indicative Shade Pattern (where appropriate)

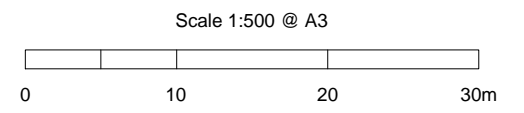

NOTES

All dimensions to be verified on site. Do not scale this drawing, use figured dimensions only. All discrepancies to be clarified with project Arboriculturalist. Drawing to be read in conjunction with Arboricultural Assessment and Appendix A - Tree Schedule.

Drawing has been produced in colour and is based on digital information in .dwg format, aerial images and/or GPS location where appropriate. A monochrome copy should not be relied upon. The exact position of individual trees or species included as part of a tree group, woodland or hedgerow should be checked and verified on site prior to any decisions for foundation design, tree operations or construction activity being undertaken. Further survey work would be required for calculating foundation depths.

Trees are living organisms that change over time, the condition of all trees illustrated herein, are to be checked by the project Arboriculturalist should works commence 12 months after the date of this survey.

SOME TREES MAY BE SUBJECT TO STATUTORY CONSTRAINTS. IT IS THEREFORE ADVISED THAT NO WORKS SHOULD BE UNDERTAKEN TO ANY TREES ILLUSTRATED HEREIN WITHOUT FIRST OBTAINING THE RELEVANT AUTHORISATION TO DO SO UNLESS AGREED AS PER THE APPROVED PLANS THROUGH PLANNING CONSENT.

This drawing is the property of FPCR Environment and Design Ltd and is issued on the condition it is not reproduced, retained or disclosed to any unauthorised person, either wholly or in part without written consent of FPCR Environment and Design Ltd. FPCR Environment and Design Ltd accept no liability for third party use.

Ordnance Survey material is used with the permission of The Controller of HMSO, Crown copyright 100018896.

-	19.07.17	First Issue	TJR
A	20.07.17	Layout amendment - 17003 - 01M (Site Plan)	TJR
rev	date	description	by

fpcr

- masterplanning
- environmental assessment
- landscape design
- urban design
- ecology
- architecture
- arboriculture

FPCR Environment and Design Ltd
 Lockington Hall
 Lockington
 Derby DE74 2RH

t: 01509 672772
 f: 01509 674565
 e: mail@fpcr.co.uk
 w: www.fpcr.co.uk

client
Bellway Homes Limited (West Midlands)

project
**Bramshall Road
 Uttoxeter**

drawing title
TREE RETENTION PLAN

scale
 1:500 @ A3

drawn
 TJR

date
 July 2017

drawing number
4348-A-07

rev
A